



PANEL PUNCHING



E-Rail offers a complete line of control panel punching tools, dies and tungsten carbide TCT hole saws. Our electric and hydraulic tools combined with a comprehensive line of punches (round, square and rectangular) will meet all of your punching applications. We can also supply special dies within eight weeks.

Toll-Free 888.222.9570 FAX 773.442.0135

www.dinmountingrail.com



**AKKU High performance - easy handling,
battery operated compact hydraulic punch.**

AKKU Basic Kit #02070

Includes ALFRA battery packed compact hydraulic punch
2 Rechargeable batteries - 18v
Battery Charger 18-28v
Hydraulic screw - 9.5 x 19mm dia.
Hydraulic screw - 19 x 120mm dia.
Distance bush, 3 pieces
Pre-drill Ø 11mm dia.
Case and Manual

**COMPACT lightweight (high tensile aluminum)
hand hydraulic punch with pressure relief valve and
ergonomic handle.**

COMPACT Basic Kit #02001

Includes COMPACT hydraulic punch
Hydraulic screw - 19mm dia.
Hydraulic screw - 19 x 9.5mm dia.
Hydraulic screw - 19 x 11.1mm dia.
Distance bush, 3 pieces
Pre-drill Ø 11mm dia.
Case and Manual



Tool Only #02005

**COMBI lightweight (high tensile aluminum) hand
hydraulic punch with 360* rotating head, pressure relief
valve and ergonomic handle.**



COMBI Basic Kit #02049

Includes COMBI hydraulic punch
Hydraulic screw - 19mm dia.
Hydraulic screw - 19 x 9.5mm dia.
Hydraulic screw - 19 x 11.1mm dia.
Distance bush, 3 pieces
Pre-drill Ø 11mm dia.
Case and Manual

Tool Only #02055

**ALFRA TOOLS & DIES ARE
INTERCHANGEABLE WITH ALL COMPETITORS**



ALFRA ROUND PUNCHES AND DIES



TRISTAR



TRISTAR PLUS
Stainless Steel



STANDARD

Description:	Set	Punch	Die	Set	Punch	Die	Set	Punch	Die
1/2" Nominal	01770	01675	01676				01002	01003	01004
3/4" Nominal	01686	01687	01688	01603	01604	01605	01026	01027	01028
1" Nominal	01776	01696	01697	01659	01660	01661	01058	01059	01060
1-1/4" Nominal	01780	01709	01710	01618	01619	01620	01102	01103	01104
1/2" Conduit	01775	01693	01694	01609	01610	01611	01046	01047	01048
3/4" Conduit	01777	01699	01700	01612	01613	01614	01069	01071	01072
1" Conduit	01788	01792	01793	01618	01619	01620	01118	01119	01120
1-1/4" Conduit	01789	01794	01795	01624	01625	01626	01162	01161-ST	01161-MA
1-1/2" Conduit	01790	01796	01797	01630	01631	01632	01170	01171	01172
2" Conduit	01791	01798	01799	01640	01641	01644	01206	01207	01208
22.5mm	01692	01693	01694	01609	01610	01611	01046	01047	01048
30.5mm	01779	01704	01705	01615	01616	01617	01094	01095	01096

Set includes punch, die, screw Set includes punch, die only Set includes punch, die, screw

ALFRA SQUARE and RECTANGULAR PUNCHES AND DIES



Square and Rectangular Punch/Die Sets: (Include Punch, Die, Screw, Nut, Case)

Size	Part No.	Tie Bolt	Locknut	Pre Drill
45.5mm x 45.5mm	1/16 DIN (Square) 01313	01345	01350	20mm (3/4")
45mm x 92mm	1/8 DIN 01314	01344	01349	24mm (7/8")
92mm x 92mm	1/4 DIN 01309	01343	01349	30mm (1 3/16")
22mm x 45mm	1/32 DIN 01375	01360	01351	16mm (5/8")

NUMEROUS OTHER ROUND, SQUARE AND RECTANGULAR SIZES ARE AVAILABLE

**CUSTOM DIE SETS ARE OUR SPECIALTY
QUICK 8 WEEK DELIVERY**

E-Rail

TCT HOLE SAWS

Manufactured with the highest grade German tungsten carbide and attached to a thicker single piece steel body these TCT Hole Saws provide effortless hole drilling.

NOMINAL

15.5mm (9/16")	#0600152
16mm (5/8")	#0630160
19mm (3/4")	#0630190
26mm (1")	#0630260
32mm (1-1/4")	#0630320

CONDUIT

22.5mm (1/2")	#0630230
28.3mm (3/4")	#0630290
34.5mm (1")	#0630350
43.2mm (1-1/4")	#0630450
50mm (1-1/2")	#0630510
62.5mm (2")	#0630620

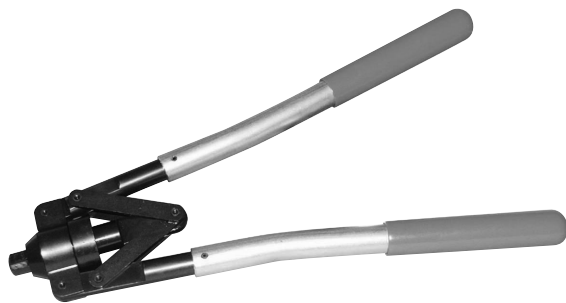
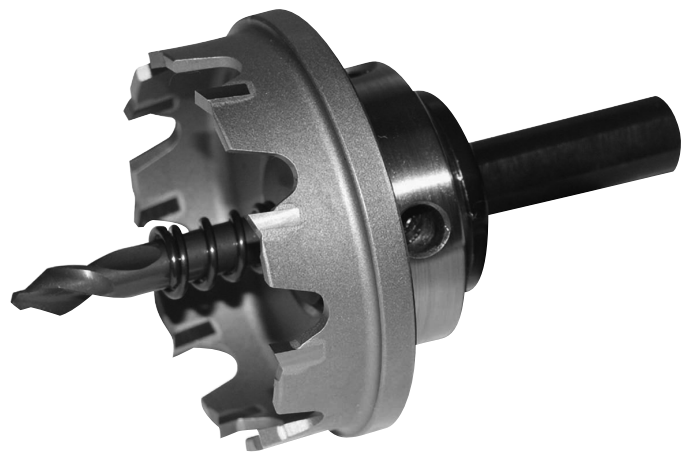

NOTCHING TOOL

Quickly and easily punches notches in sheet metal up to 2.5 mm

Part #03015

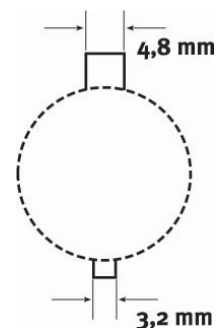

Toll-Free 888.222.9570 FAX 773.442.0135

www.dinmountingrail.com